

<b>Subject:</b>  MIL ON / P2004 SETS AFTER STARTING ENGINE	<b>Bulletin No:</b> 01-055/06
	<b>Last Issued:</b> 12/20/2006

## APPLICABLE MODEL(S)/VINS

2004-2005 Miata

2004-2005 MAZDASPEED MX-5

## DESCRIPTION

On some vehicles, after sitting overnight and started, the MIL comes on and DTC P2004 sets into PCM memory. This occurs because vacuum (momentarily) does not flow into the Variable Tumble Control System (VTCS) shutter valve actuator. The contact surface between the valve and the valve body inside the check valve is smooth causing the valve to momentarily stick before more vacuum applies, opening the valve.

As a mass-production change, the contact surface between the valve and valve body has been made rougher to prevent sticking condition. Customers having this concern should have their vehicle repaired using the following repair procedure.

## REPAIR PROCEDURE

1. Verify customer concern.
2. Replace check valve with a modified part.

### NOTE:

- Modified check valve can be identified by Yellow marking on the valve body.

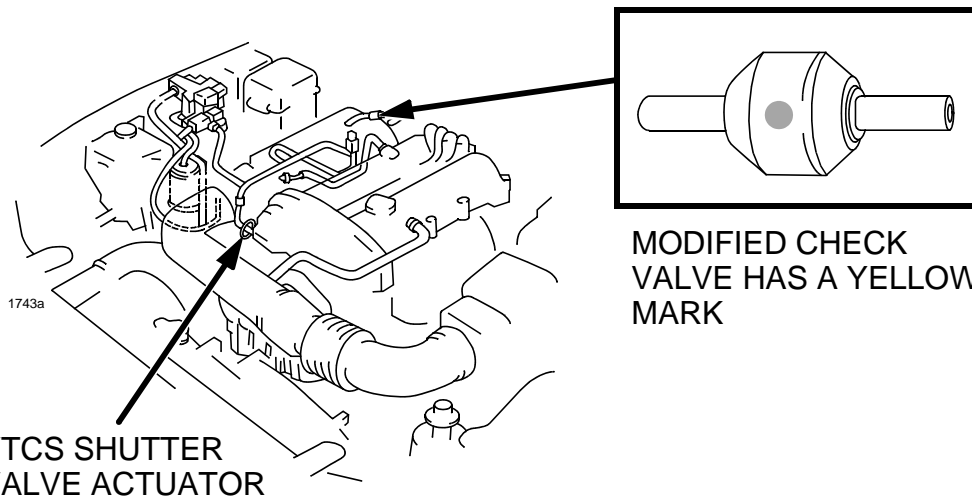

3. Verify repair.

<b>Bulletin No:</b> 01-055/06 © 2006 Mazda Motor of America, Inc.	<b>Last Issued:</b> 12/20/2006
--	--------------------------------

## PART(S) INFORMATION

Part Number	Description	Qty.	Notes
BPYJ-13-995	Check valve	1	---

## WARRANTY INFORMATION

### NOTE:

- This warranty information applies only to verified customer complaints on vehicles eligible for warranty repair. Refer to the Warranty Wizard for warranty term information.
- Additional diagnostic time cannot be claimed for this repair.

Warranty Type	A
Symptom Code	6X
Damage Code	92
Part Number Main Cause	BPYJ-13-995
Quantity	1
Operation Number / Labor Hours:	XXB457R1 / 1.2 Hrs. (BP) XXB457R2 / 0.2 Hrs. (BP With TC)