

© 2006 Mazda Motor of America, Inc.

Subject: SQUEAKING NOISE FROM CLUTCH PEDAL WHEN DEPRESSED	Bulletin No: 05-002/06
	Last Issued: 4/26/2006

APPLICABLE MODEL(S)/VINS

2006 MX-5 vehicles with VINs lower than JM1 NC**** ** 111723 (produced before January 1, 2006)

DESCRIPTION

Some vehicles may exhibit a squeaking noise when the clutch pedal is depressed. The squeaking noise comes from the starter interlock switch.

As a mass-production change, the plastic material in the starter interlock switch has been changed. Customers having this concern should have their vehicle repaired using the following repair procedure.

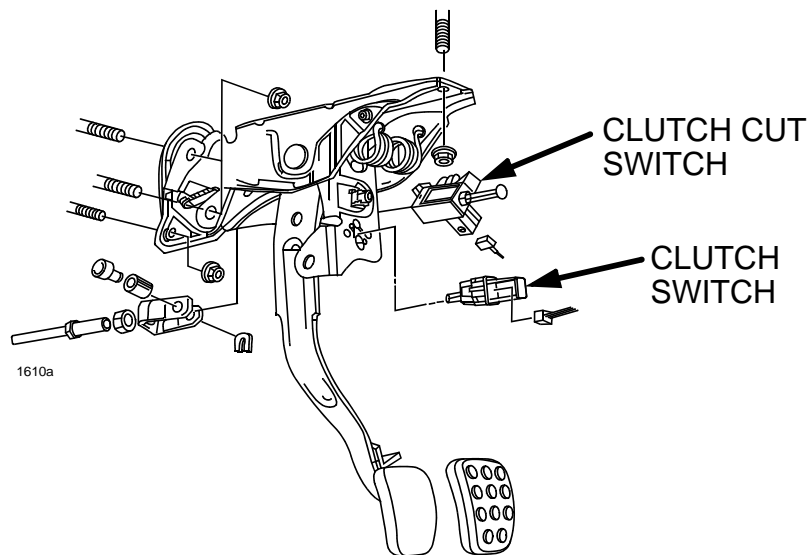

REPAIR PROCEDURE

1. Verify customer concern.
2. Replace starter interlock switch (referred to as Switch, Clutch Cut in EPC). See Workshop Manual section 05-10 CLUTCH PEDAL REMOVAL/INSTALLATION
3. Verify repair.

CONSUMER NOTICE: The information and instructions in this bulletin are intended for use by skilled technicians. Mazda technicians utilize the proper tools/equipment and take training to correctly and safely maintain Mazda vehicles. These instructions should not be performed by "do-it-yourselfers." Customers should not assume this bulletin applies to their vehicle or that their vehicle will develop the described concern. To determine if the information applies, customers should contact their nearest authorized Mazda dealership. Mazda North American Operations reserves the right to alter the specifications and contents of this bulletin without obligation or advance notice. All rights reserved. No part of this bulletin may be reproduced in any form or by any means, electronic or mechanical---including photocopying and recording and the use of any kind of information storage and retrieval system ---without permission in writing.

Bulletin No: 05-002/06 © 2006 Mazda Motor of America, Inc.	Last Issued: 4/26/2006
--	-------------------------------

PART(S) INFORMATION

Part Number	Description	Qty.	Notes
NE55-66-4D0	Switch, Clutch Cut	1	Starter Interlock Switch

WARRANTY INFORMATION

NOTE:

- This warranty information applies only to verified customer complaints on vehicles eligible for warranty repair. Refer to the Warranty Wizard for warranty term information.
- Additional diagnostic time cannot be claimed for this repair.

Warranty Type	A
Symptom Code	82
Damage Code	9B
Part Number Main Cause	NE55-66-4D0
Quantity	1
Operation Number / Labor Hours:	XXB292RX / 0.2 Hrs