

© 2008 Mazda Motor of America, Inc.

Subject: SOFT TOP LATCH AND/OR COVER RATTLING	Bulletin No: 09-021/08
	Last Issued: 7/30/2008

BULLETIN NOTE

This bulletin supersedes the previous bulletin 09-028/07, issued 7/18/2007. The WARRANTY INFORMATION has been revised.

APPLICABLE MODEL(S)/VINS

2006-2007 MX-5 with VINs lower than JM1 NC**** ** 134259 (built before January 15, 2007)

DESCRIPTION

Some vehicles may exhibit a rattling noise from the soft top latch cover caused by looseness in the soft top latch cover.

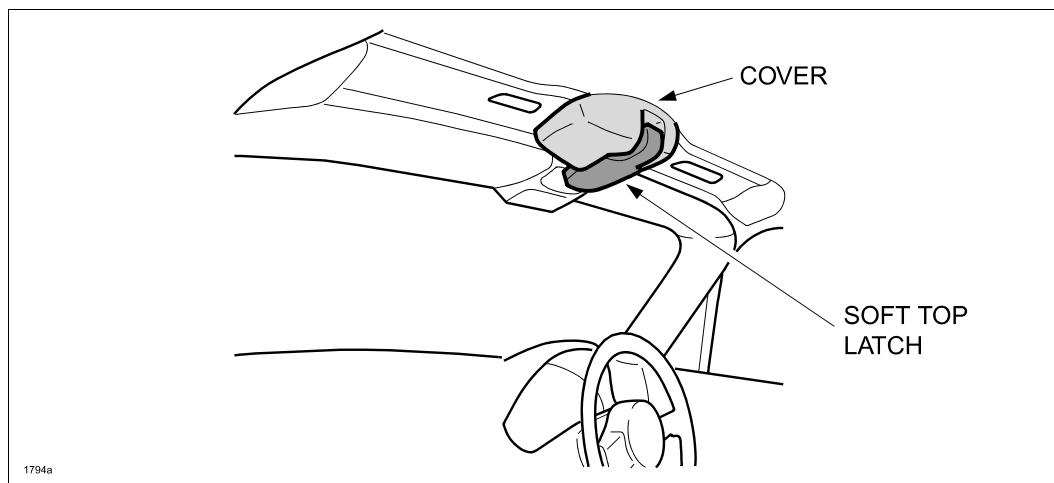

As a mass production change to prevent the noise, a pad has been attached to the location where the soft top cover is making the noise. Customers having this concern should have their vehicle repaired using the following repair procedure.

REPAIR PROCEDURE

1. Verify customer concern.
2. Remove the soft top latch cover.
 - a. Using a plastic windshield setting tool or equivalent, half-disengage the soft top latch hook.

NOTE:

- Plastic Windshield Setting Tool (Part Number IS742 - available from Equalizer at 800-334-1334) or similar available through a local supplier.

- If a flat-tipped screwdriver is to be used, wrap the tip in tape to prevent damage to the soft top latch cover.
- Do not completely disengage the hook at this step yet. (Just half release the hook engagement.)

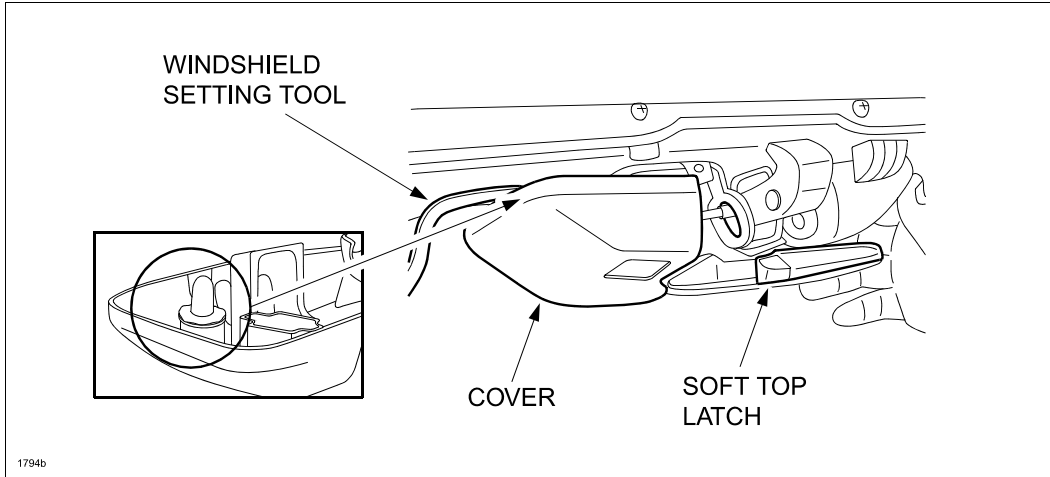

- b. Using a plastic windshield setting tool or equivalent, remove the soft top latch cover hook holder from the soft top latch hook.
- Right side: While strongly pushing the soft top latch cover inward, insert the fiber stick (or equivalent tool) as shown below, then pry down.
 - Left side: While strongly pushing the soft top latch cover inward, insert the fiber stick (or equivalent tool) as shown below, then pry downward.

NOTE:

- While strongly pushing the soft top latch cover inward, insert the fiber stick (or equivalent tool) as shown below, then pry downward.

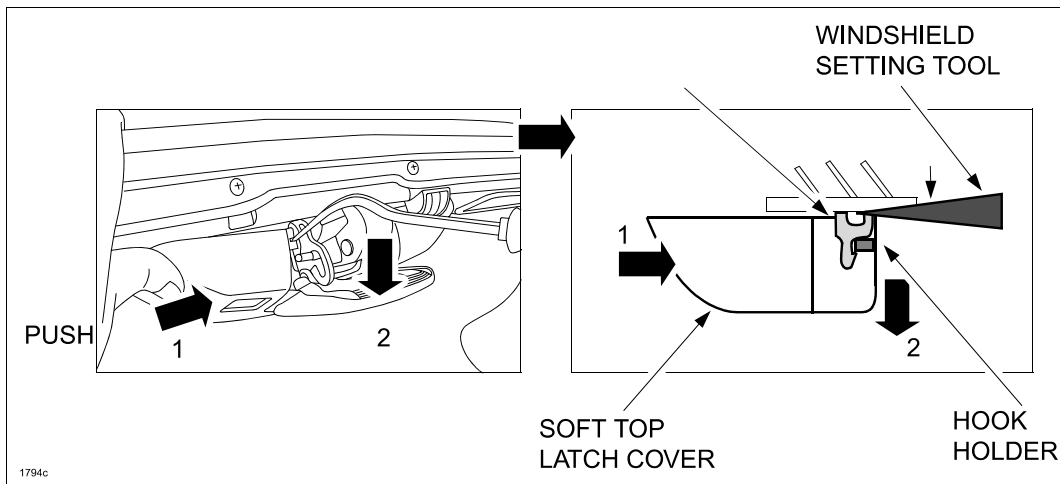

- c. Remove the cover.

