

## Disassembly / Inspection / Assembly

1. Disassemble in the order shown in the figure.
2. Inspect all parts and repair or replace as necessary.
3. Assemble in the reverse order of disassembly, referring to **Assembly Note**.

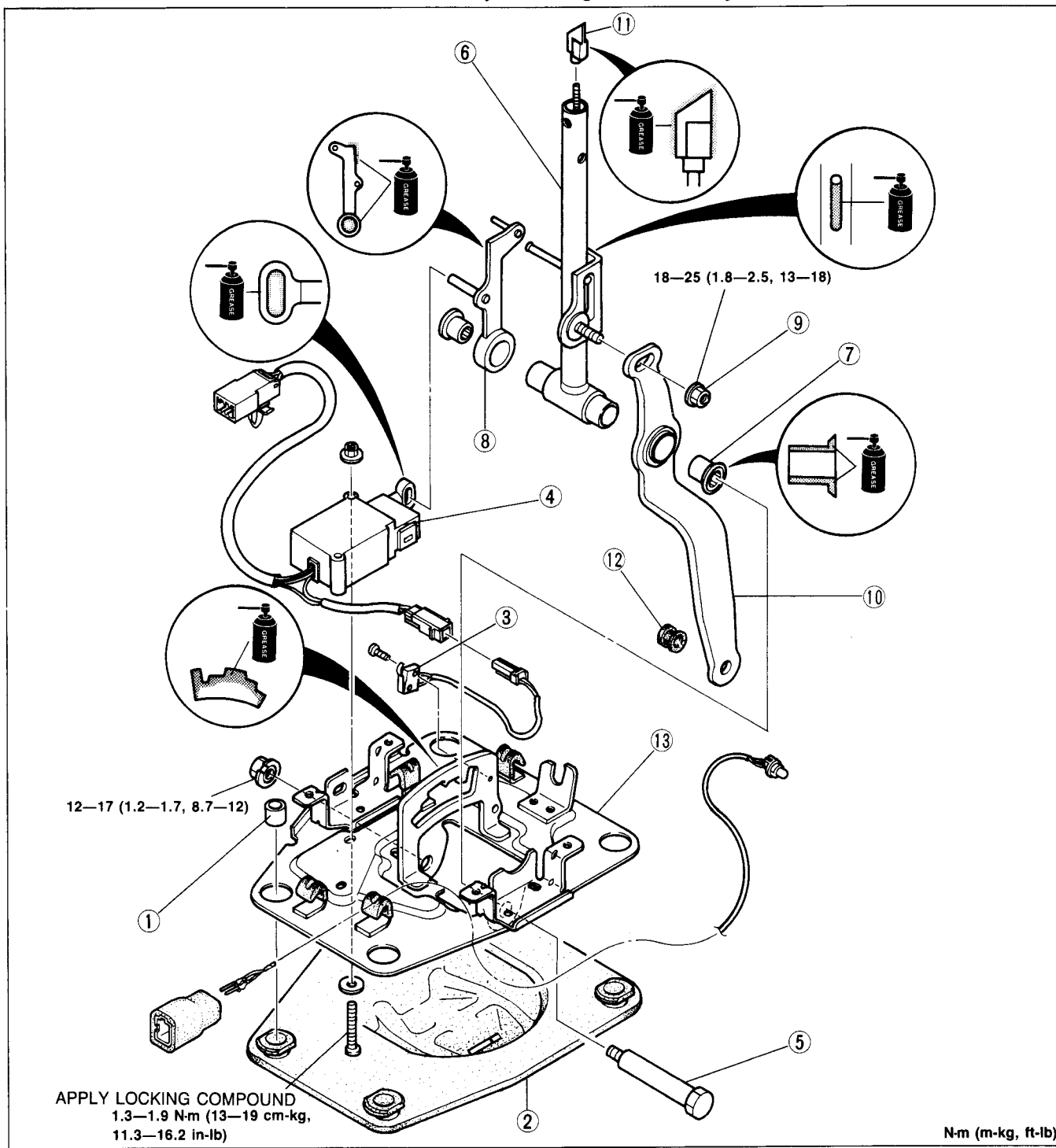

15U0KX-106

- |                                       |            |
|---------------------------------------|------------|
| 1. Spacer                             |            |
| 2. Boot                               |            |
| 3. P range switch                     |            |
| Inspection.....                       | page K-137 |
| 4. Shift lock actuator                |            |
| 5. Spindle                            |            |
| 6. Push rod assembly                  |            |
| Inspect for smooth operation          |            |
| Inspect guide pin for damage and wear |            |

- |                             |            |
|-----------------------------|------------|
| 7. Bushing                  |            |
| 8. Lock lever               |            |
| 9. Locknut                  |            |
| 10. Adjustment lever        |            |
| 11. Cam                     |            |
| Assembly Note.....          | page K-146 |
| 12. Bushing                 |            |
| Inspect for damage and wear |            |
| 13. Selector lever bracket  |            |