

Subject: ACCESSORY POWER PLUG / CHARGER STUCK IN ACCESSORY SOCKET	Bulletin No: 09-013/10
	Last Issued: 04/08/2010

BULLETIN NOTE

- This bulletin supersedes the previous bulletin 09-013/10 issued on 02/24/10. The APPLICABLE MODEL(S)/VINS, REPAIR PROCEDURE, and WARRANTY INFORMATION have been revised.
- Changes are noted below in Red beside the change bar.

APPLICABLE MODEL(S)/VINS

2009-2010 Mazda6 vehicles (produced before December 21, 2009)

2009-2010 MX-5 vehicles with VINs lower than JM1NC*****209095 (produced before January 19, 2010)

2009-2010 RX-8 vehicles with VINs lower than JM1FE*****404477 (produced before January 19, 2010)

2010 Mazda3 vehicles with VINs lower than JM1BL*****275497 (produced before January 19, 2010)

2010 Mazda5 vehicles with VINs lower than JM1CR*****374528 (produced before January 19, 2010)

2010 CX-7 vehicles with VINs lower than JM3ER*****322180 (produced before January 19, 2010)

2010 CX-9 vehicles with VINs lower than JM3TB*****215587 (produced before January 19, 2010)

DESCRIPTION

Some aftermarket power plug / chargers may become stuck in the accessory socket. This is caused by the negative spring contacts of the power plug / charger locking into the slots of the accessory socket. A modified accessory socket is now available to prevent this from happening.

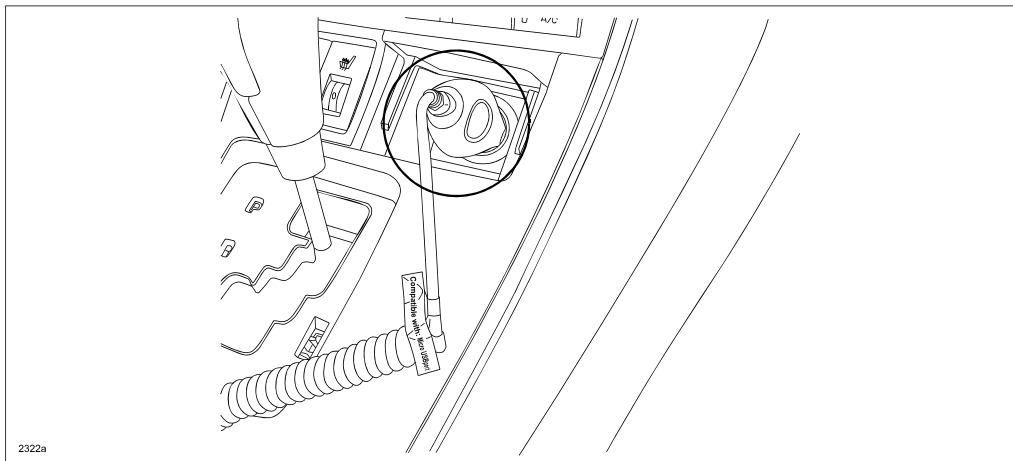

Customers having this concern should have their vehicle repaired using the following repair procedure.

REPAIR PROCEDURE

1. Verify customer concern.

NOTE: It is not necessary to replace all the accessory sockets in a vehicle, even though most vehicles have at least two. Only replace those that have a power plug / charger stuck in them.

2. Remove the accessory socket together with stuck accessory power plug / charger from the vehicle.

NOTE: DO NOT attempt to remove the stuck accessory power plug / charger from the accessory socket until step 3, otherwise damage may occur.

- For removal of the accessory socket in the dash or in the center console, refer to MS3 online instructions section 09-20.
- **For removal of the accessory socket on the trunk side trim:**
 - a. Remove the rear package tray and the trunk end trim.
 - b. Remove the screws or the fasteners securing the trunk side trim, then detach the upper end of the trunk side trim (A).
 - c. Access the accessory socket (B) by moving the rear end of the trunk side trim out.

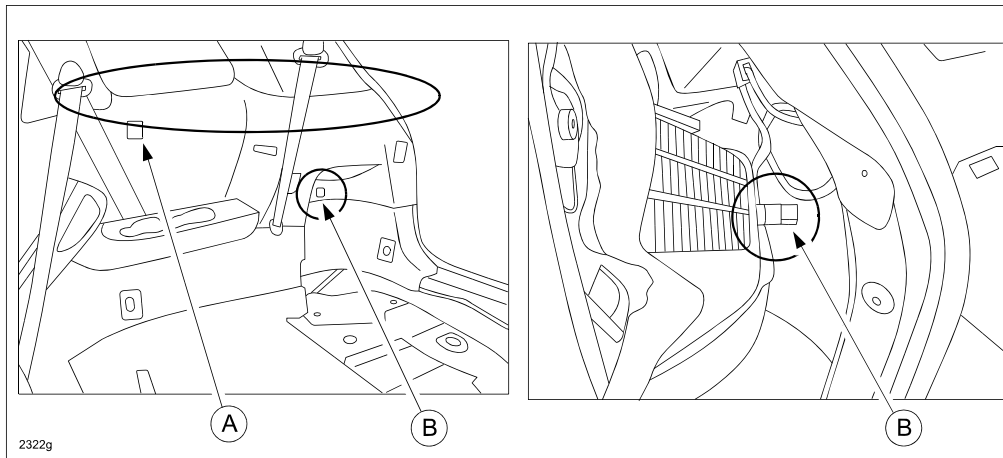

3. Remove the accessory socket (E) in the direction of the arrow as shown while carefully releasing both anchor tabs of the cap (D) using a fastener remover wrapped in tape.

A: Cap

B: Trim

C: Aftermarket accessory

NOTE: There are two anchor tabs, one on each side of the cover.

CAUTION: Pry outward just enough to release the tabs so as not to break them.

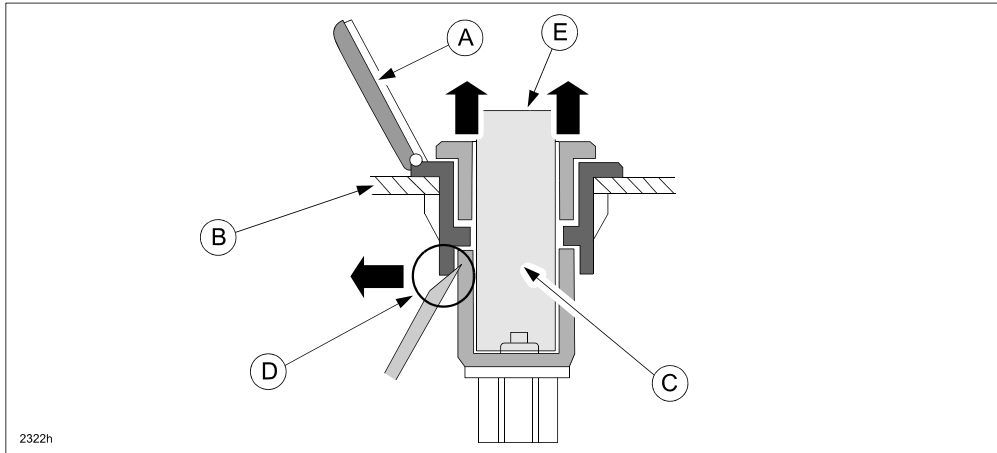

4. To remove the accessory power plug / charger from the old accessory socket, do the following:

- a. Secure the plastic connector housing of the accessory socket in a vice.

NOTE: DO NOT overtighten the vise and break the plastic connector housing, otherwise the rivet connecting the plastic connector housing to the socket will have to be drilled out.

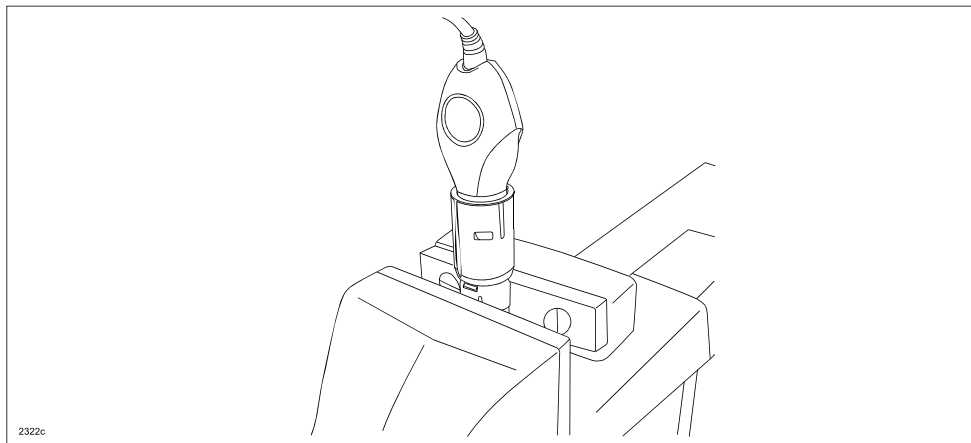

- b. Take hold of the upper part of the accessory socket and accessory power plug / charger, then pull towards you until the plastic connector separates from the housing.

NOTE: Grab as much of the socket as possible to prevent breaking the accessory power plug / charger.

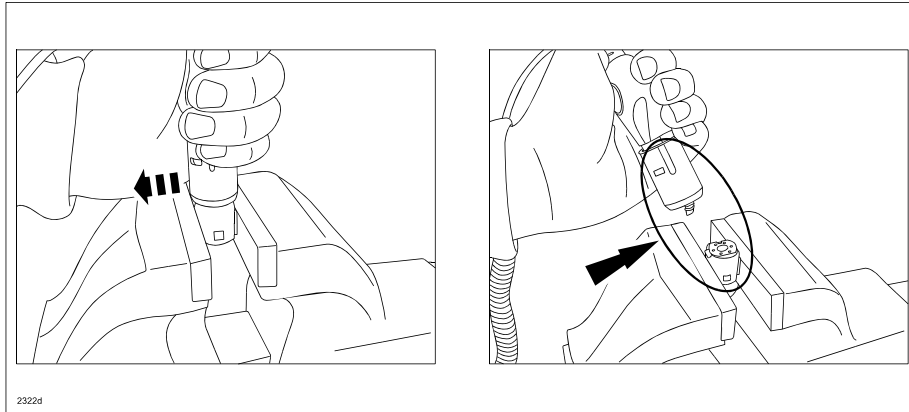

- c. Remove the outer housing from the the inner housing.

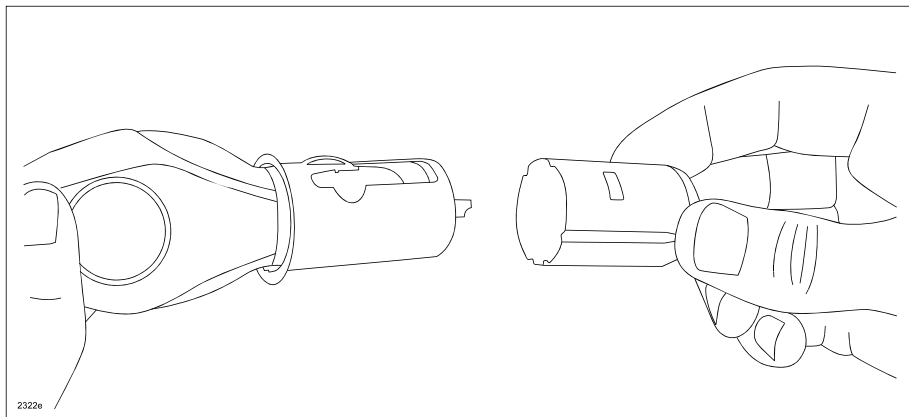

- d. Pry and bend the metal tabs upward on both sides of the inner housing using a small flat screwdriver, then remove the accessory power plug / charger from the inner housing.

NOTE: Discard the original accessory socket.

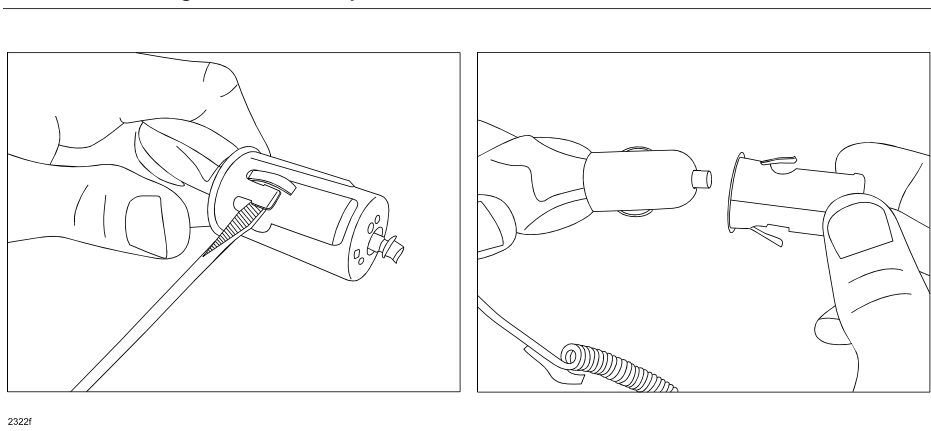

5. Install the new accessory socket (and cap) in the vehicle.
6. Verify repair, and return accessory power plug / charger to customer.

PART(S) INFORMATION

Part Number	Description	Qty.
CD83-66-297B	Socket, outlet	1

WARRANTY INFORMATION

NOTE:

- This warranty information applies only to verified customer complaints on vehicles eligible for warranty repair.
- This repair will be covered under Mazda's New Vehicle Limited Warranty term.
- Additional diagnostic time cannot be claimed for this repair.

Warranty Type	A	
Symptom Code	90	
Damage Code	97	
Part Number Main Cause	CD83-66-297B	
Quantity	1	
Operation Number / Labor Hours:	Socket on center panel	
	XXF1DARX:	0.3 Hrs. (Mazda3, Mazda5 with rear vent) 0.4 Hrs. (CX-9) 0.5 Hrs. (Mazda6, MX-5)
	XXF1DDRDX:	0.4 Hrs. (Mazda5 without rear vent)
	Socket on console	
	XXF1DBRX:	0.4 Hrs. (Mazda3) 0.5 Hrs. (Mazda6, CX-7, RX-8) 0.6 Hrs. (CX-9)
	Socket on trunk side trim	
	XXF1DCRX:	0.4 Hrs. (Mazda5, CX-9)